

90° Elbows Long Radius

10Bar

14Bar

16Bar

20Bar

Material: CuNi 90/10
CuNi 70/30

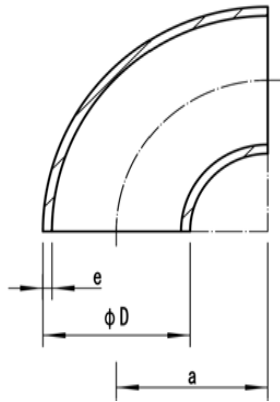

Outside diameter of pipe		DIN 86090						EEMUA 146					
		10Bar			14Bar			16Bar			20Bar		
ØD		Wall thickness	Radius	Theoretical weight	Wall thickness	Radius	Theoretical weight	Wall thickness	Radius	Theoretical weight	Wall thickness	Radius	Theoretical weight
nominal	actual	e	a	Kg/piece	e	a	Kg/piece	e	a	Kg/piece	e	a	Kg/piece
inch	mm	mm	mm		mm	mm		mm	mm		mm	mm	
0.5	20	1	25	0.02	1	25	0.02	-	-	-	-	-	-
0.75	25	1.5	27.5	0.04	1.5	27.5	0.04	2	31.2	0.076	2	31.2	0.076
1	30	1.5	33.5	0.06	1.5	33.5	0.06	2.5	38	0.12	2.5	38	0.12
1.25	38	1.5	45	0.1	1.5	45	0.1	2.5	48	0.18	2.5	48	0.18
1.5	44.5	1.5	51	0.14	1.5	51	0.14	2.5	57	0.26	2.5	57	0.26
2	57	1.5	72	0.26	1.5	72	0.26	2.5	76	0.46	2.5	76	0.46
2.5	76.1	2	95	0.61	2	95	0.61	2.5	95	0.76	2.5	95	0.76
3	88.9	2	114.5	0.87	2.5	114.5	1.08	2.5	114	1.08	2.5	114	1.08
4	108	2.5	142.5	1.64	2.5	142.5	1.64	3	152	2.1	3	152	2.1
5	133	2.5	181	2.58	3	181	3.1	-	-	-	-	-	-
6	159	2.5	216	3.7	3	216	4.44	3	229	4.7	3.5	229	5.48
7	193.7	2.5	270	5.65	3.5	270	7.88	-	-	-	-	-	-
8	219.1	3	305	8.66	3.5	305	10.08	4	305	11.5	4.5	305	12.94
10	267	3	378	13.1	4	378	17.46	4.5	381	19.7	5.5	381	24.08
12	323.9	4	457	25.61	5	457	32	5.5	457	35.06	7	457	44.6
14	368	4	533.5	34	5.5	533.5	46.74	6.5	533	54.92	8	533	67.6
16	419.1	4	609.5	39.4	6	609.5	66.4	7	610	77	9	610	99
18	457.2	4	686	48.4	6	686	72.63	8	686	108.2	9.5	686	128.5
20	508	4.5	762	75.62	6.5	762	125.7	8.5	762	141.86	11	762	183.6
24	610	5	915	121.24	8	915	194	10.5	914	252.94	13	914	313.3

Pipe Fittings



Shanghai Shihang Copper Nickel Pipe Fittings Co., Ltd.

TEL:86-21-58050989 FAX:86-21-68291168 E-mail:sales@shshihang.com Website:www.shshihang.com